Related Events

1. Artist Talk by Finalists

The finalists introduce and discuss their artworks.

September 16 (Sat) 15:00-16:30 Hikaru Fujii, Ryuichi Ishikawa, Yuichiro Tamura

September 23 (Sat) 15:00-16:00 Motoyuki Daifu, Nami Yokoyama

Venue: 2F Library / Capacity: 40 / Reservation required

2. Talk by Grand Prix Winner

Grand Prix Winner discusses current exhibit and future work.

September 30 (Sat) 15:00-16:00

With Eriko Kimura (Candidates Nomination Committee Member / Curator, Yokohama Museum of Art)

Venue: 1F Cafe / Capacity: 40 / Reservation required

3. Family Programs (Ages: 5 to 9 and their guardians and families.)

Workshop: September 23 (Sat) 10:30-12:00

Listen to commentary on the exhibited works and make your own award.

Guided Tour: October 14 (Sat) 10:30-11:30

Explore the exhibition through a specially designed guided tour for children and their families.

Venue: Exhibition space, 2F Library / Capacity: 20 / Reservation required

4. Guided Tour

Tour by Nissan Art Award Project staff, providing commentary on the artworks.

September 29 (Fri) 16:30-17:15

October 14 (Sat) 13:00-13:45

October 21 (Sat) 13:00-13:45

October 27 (Fri) 16:30-17:15

Capacity: 20 / Please come to the exhibition entrance as reservation is not required.

*Conducted in Japanese.

*Free admission

*Speakers and events subject to change without notice.

*For details, please refer to Exhibition and Events page on the Nissan Art Award website or ask our staff at the reception.

Collateral exhibition from the Nissan Art Collection

Nissan Art Award 2013 finalist and Special Jury Prize Winner Tatzu Nishi exhibits his works, *Perry's squadron*, at YCC Gallery, Yokohama.

Exhibition Period: September 18 (Mon/National Holiday) - November 5 (Sun)

Opening Hours: 11:00-19:30 (Last day until 17:00)

Venue: YCC Yokohama Creativecity Centre, 1F gallery (6-50-1 Hon-cho, Naka-ku, Yokohama)

*Free admission

<http://yokohamacc.org/ycg/nissanartaward/>

NISSAN ART AWARD

Exhibition of New Works by Five Finalists

BankART Studio NYK 2F

September 16 (Sat) – November 5 (Sun), 2017

Organized and sponsored by Nissan Motor Co., Ltd.

Directed, coordinated and exhibition curated by Arts Initiative Tokyo [AIT]

In association with International Studio & Curatorial Program (ISCP)

Exhibition support by BankART 1929, Light and Licht Ltd, PAP-design / Kanpis LLC

Associate support by City of Yokohama

Official website: <http://www.nissan-global.com/EN/CITIZENSHIP/NAA/>

Facebook: <https://www.facebook.com/NissanArtAward>

Twitter: <https://twitter.com/NissanArtAward>

About artworks

1 Ryuichi Ishikawa

Photographer Ryuichi Ishikawa documents landscapes and the lives of people, with a particular focus on Okinawa, where he was born. In his work, the dense communication processes that unfold with those he meets as well as the locality and unique character of Okinawa are intensely replicated. This exhibition features new work showing Ishikawa's home and the view from his window. From such familiar spaces as an entrance hall, bedroom, bathroom, balcony and kitchen, to the virtual space inside a computer, or buildings outside, military aircraft in the skies, and birds, the present-day situation in Okinawa captured by Ishikawa's lens is arranged side by side with everyday life. [Ishikawa's upcoming plans include an exhibition at ATSUKO BAROUH from November 11th to December 10th of a series of work shot in France as well as publishing a new photo book.]

home work
2017

Dimensions variable / Archival Pigment Print

2 Hikaru Fujii

Through a process of research into the specific local history of various locations as well as interviews with the people who live there, Hikaru Fujii creates video work and installations exploring the systems that shape our society from a perspective that connects past and present. This exhibition features an installation of a new work combining texts and video documentation of a workshop on the theme of *Performing the Japanese*. The results reflect the participants' behavior and ideas about history and diversity, posing questions for the viewer to consider. [Fujii's upcoming plans include presenting a new work as part of a 40th-anniversary exhibition at the National Museum of Art, Osaka in 2018.]

Playing Japanese
2017

Dimensions variable / Installation, photo, video (40min)

3 Nami Yokoyama

Nami Yokoyama draws on the history of painting in her work depicting the things often overlooked in everyday life as well as their significance. This exhibition features seven artworks, including new pieces, from her recent series dealing with neon signage. To produce the work, Yokoyama designed and created neon in the shape of an actual object, which she then used as the basis for the oil painting. The text used in one of the paintings is taken from reference books about Western art history. In addition, the portraits of the man and woman as well as the cross symbolize motifs frequently found in the history of painting, such as in nudes and religious paintings. While neon emits bright and colorful lights, it also has a hidden side that is not normally noticed, such as electrical cables and the structures that support these. Yokoyama also depicts these things that are indispensable for emitting light in an attempt to express within a painting what we cannot look at and the value these things have. [Yokoyama's upcoming activities include a solo exhibition at Kenji Taki Gallery in Nagoya in 2018.]

Story 2017 130.3 x 162 cm / Oil on linen	Sexy women 2017 130.3 x 130.3 cm / Oil on linen	Crucifix 2017 162 x 130.3 cm / Oil on linen	Sexy men 2017 130.3 x 130.3 cm / Oil on linen
---	--	--	--

The history of Western painting 2017 194 x 259 cm / Oil on linen	PAINTING 2017 91 x 116.7 cm / Oil on linen	Window 2017 100 x 100 cm / Oil on linen
---	---	--

*Information is provided for each work in the following order: Artist name, title, year completed, dimensions (h x w x d cm) and medium/method.

*Please refrain from touching any exhibited works. *  Please keep off the designated area.

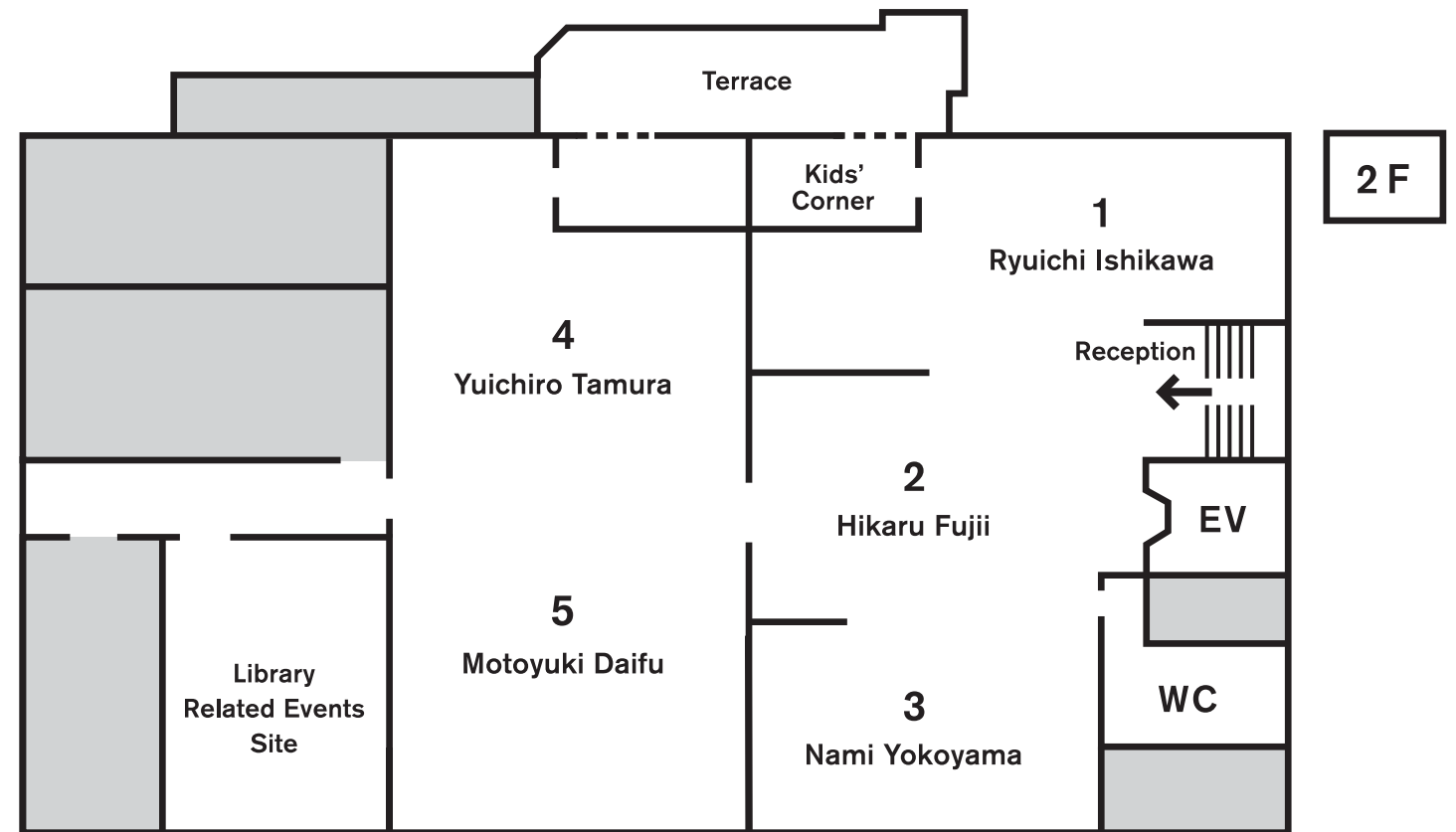

4 Yuichiro Tamura

The work of Yuichiro Tamura connects the relationships between specific places, contexts and history, combining various forms of expression such as video, photography, performance, and installation. This exhibition features a new work on the theme of glory and demise, rise and fall. Tamura ties the motif of glory to a 1980s pop song as well as classical music, luxury cars, and Greek architecture that displayed the zenith of the classical world. With his second theme, Tamura intersects various cultures, forms of expression, and vast amounts of information, including a play by Samuel Beckett that evokes a sense of demise as well as the idea of a fall from glory. The elements are linked within the exhibits, which include video, transforming the space at BankART into a three-dimensional artwork. These elements connecting different ages and places initially seem unrelated to one another, but subtly weave together various causal relationships in history and tales of rise and fall, and then rebirth.

[In 2017, Tamura's work can also be seen in a solo exhibition at Oyama City Kurumaya Museum of Art as well as at Yokohama Triennale and Hamburger Bahnhof – Museum für Gegenwart – Berlin.]

End Game
2017

Dimensions variable / Installation

5 Motoyuki Daifu

From supermarket ready meals and condiments to a table overflowing with boxes and snack packets, and a room filled with futons and laundry, Motoyuki Daifu's photographs show the everyday landscapes of families and regular life that at first appear cluttered and disorderly. His work reflects colorful household items as well as families that live surrounded by and jostling with them. Taken with a strong flash, the colors and depth seem detached from reality, conjuring up a sense of the extraordinary that is quite distinct from documentary photography. This exhibition features previously unreleased work and other examples from his series *STILL LIFE*, which focused on the colors and composition of things arranged on a dining table, as well as new work that references the early photography of Nobuyoshi Araki, who shot empty cans that had been crushed on the road. Following on from the style of the *STILL LIFE* series, Daifu brings out the detail and texture of objects with his photography that deviates from familiar everyday scenes.

STILL LIFE
2013-2016
each 86 x 65.7cm / Chromogenic print

Crushed can (Andy Warhol)
2017
each 130.5 x 87cm / Digital C-print

Dinner with the family the day after anal sex
2017
61 x 45.7cm / Digital C-print